

Modena LED Tracklight

F25343TA/F25343TK/F25343TK-d/F25348TA/F25348TK/F25348TK-d/F25349TA
F25349TK/F28048TA/F28048TK/F28048TK-d/F28049TA/F28049TK

MEGAMAN®

Instruction Manual

TECHNICAL SPECIFICATION

Model Number	F25343TA/F25343TK	F25343TK-d	F25348TA/F25348TK F28048TA/F28048TK	F25348TK-d/F28048TK-d	F25349TA/F25349TK	F28049TA/F28049TK
Lamp Holder	LB2601	LB2601	LB2602	LB2602	N/A	N/A
System Wattage	28W	28W	19W	19W	55W	27W
Voltage	220-240V~	220-240V~	220-240V~	220-240V~	220-240V~	220-240V~
Frequency	50/60Hz	50/60Hz	50/60Hz	50/60Hz	50/60Hz	50/60Hz
Dimmable	No	100-1%	No	100-1%	No	No
IP Rating	IP20	IP20	IP20	IP20	IP20	IP20
Suggested Light Source	24W MEGAMAN® TECOH® MHx MH0130	24W MEGAMAN® TECOH® MHx MH0130	17W MEGAMAN® TECOH® MHx MH0219	17W MEGAMAN® TECOH® MHx MH0219	48W MEGAMAN® TECOH® RDx RD0343M	24W MEGAMAN® TECOH® RDx RD0231M

CAUTIONS

- Read the entire manual carefully before installation and operation.
- It is recommended that the installation or replacement be performed by a licensed and qualified electrician.
- DO NOT touch the LED chip in the middle part of the lamp (the yellow chip). Doing so may result in module damage or malfunction.
- Switch off the power source before installation, replacement and cleaning.
- Wearing gloves during installation is recommended to ensure the luminaire is kept in the best condition.
- Before replacement of the luminaire or module, turn it off and allow it to cool down. Heat-resistant gloves are mandatory when handling the luminaire or module.
- The minimum safety distance from the illuminated object is 0.1m.
- Only the MEGAMAN® TECOH® module can be used with the luminaires. Using incandescent lamp, halogen or other kinds of light source will be resulted in risk of fire or electric shock.
- For non-dimmable version, it is recommended to use GLOBAL brand, pro 3-circuit track. For dimmable version, the GLOBAL brand, GLOBAL TRAC® Control Track is recommended. Dimming scene settings available when applying 1-10V dimmable track adaptor and GLOBAL TRAC® Control Track.
- MEGAMAN® LED Constant Current Converter is Safety Extra-Low Voltage (SELV) output compliant.
- The manufacturer accepts no liability for any damage resulting from the misuse of the luminaire or from when it is used with inappropriate equipment.
- Consult your dealer if you have any enquiries.

ATTENTION

- Instant start is allowed.
- Designed for indoor application.

Installation

Module Installation

If the module is already installed to the luminaire, please skip this part.

F25343TA/F25343TK/F25343TK-d

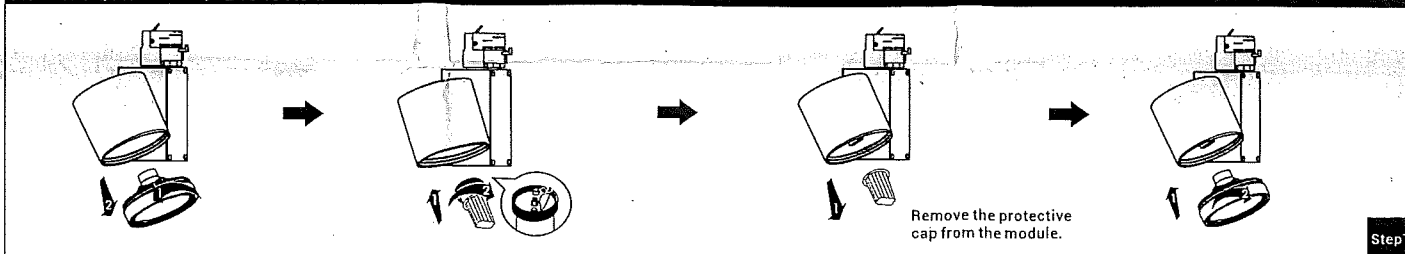

F25348TA/F25348TK/F25348TK-d/F28048TA/F28048TK//F28048TK-d

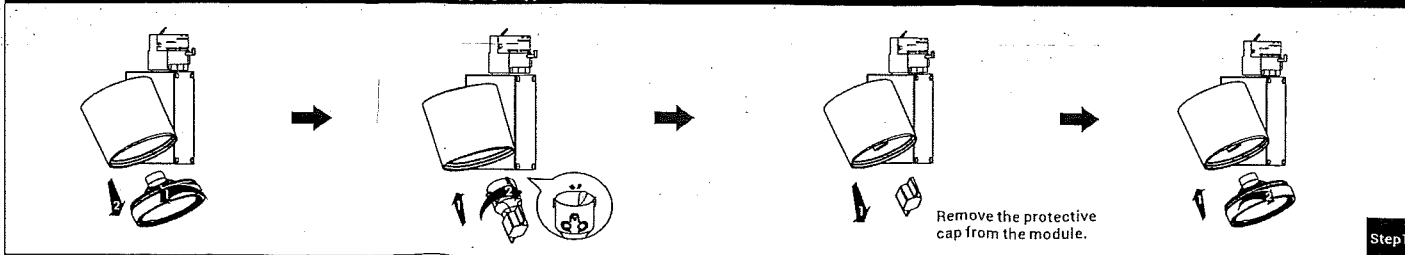

F25349TA/F25349TK/F28049TA/F28049TK

Further technical guidance is required for the relamping of F25349TA, F25349TK, F28049TA and F28049TK, please contact your local distributor for assistance.

Luminaire Installation

F25343TK/F25348TK/F28048TK/F25349TK/F28049TK

1. Install adaptor when it is at the "OFF" position and push the adaptor into the track.
 2. Turn the mechanical fixing knob clockwise to lock the adaptor into the track.
 3. Select the desired circuit (1/2/3) with the circuit selection knob.
- Pay attention to the position of the track's ridge. The ridge on the adaptor should be matched with the side of the track that has no ridge.

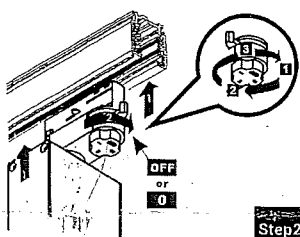

F25343TA/F25348TA/F28048TA/F25349TA/F28049TA

1. Install adaptor when both sides of the adaptor are at the "OFF" position, then push it into the track.
2. Turn both sides of the mechanical fixing knob to "ON" for locking the adaptor into the track.

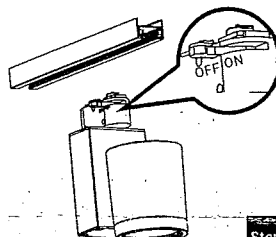

Modena LED Tracklight

F25343TA/ F25343TK/ F25343TK-d/ F25348TA/ F25348TK/ F25348TK-d/ F25349TA
F25349TK/ F28048TA/ F28048TK/ F28048TK-d/ F28049TA/ F28049TK

MEGAMAN®

Instruction Manual

F25343TK-d/ F25348TK-d/ F28048TK-d

- 1. Install adaptor when both sides of the adaptor are in "release" position, then push it into the track.
- 2. Turn both sides of the mechanical fixing knob to lock the adaptor into the track.

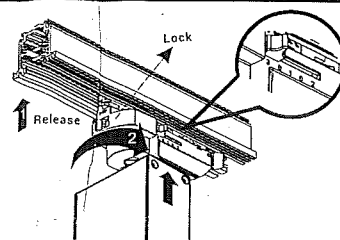

• Pay attention to the position of the track's ridge. The ridge on the adaptor should be matched with the side of the track that has no ridge.

Step2

All Models

- 1. Secure the luminaire by turning 180°.
- 2. Angle adjustment is available: the rotation angle is 355° and the tilting angle is 90°.

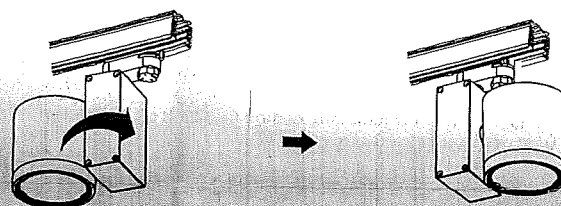

Step3

Correct Disposal of this product

This marking indicates that this product should not be disposed with other household wastes throughout the EU. To prevent possible harm to the environment or human health from uncontrolled waste disposal, recycle it responsibly to promote the sustainable reuse of material resources. To return your used device, please use the return and collection systems or contact the retailer where the product was purchased. They can take this product for environmental safe recycling.

Neonlite Electronic & Lighting (HK) Ltd.
31/F, AIA Kowloon Tower, Landmark East, 100 How Ming Street,
Kwun Tong, Kowloon, Hong Kong.

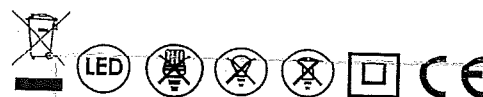

8010G0080C

GB

MEGAMAN®